



## ■ UMETA Flush-Type Grease Nipples

### Type D3



- according to DIN 3405
- angled version C / 90°
- standard versions according to DIN are made of steel, zinc-plated and passivated, with tapered thread

SW  
L1  
L2  
GW  
(all measures in mm)

wrench size  
thread length  
total length  
thread

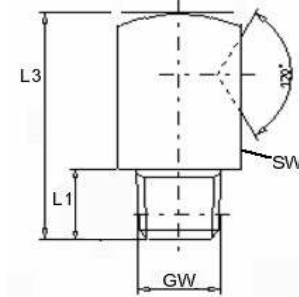

SW 9		/square		Ref.- No.:				
L1	L2	angle	thread	steel	brass	V2A	V4A	
5,5	18	90°	M6 x 1,0	3304504				
			M8 x 1,0	3304507				
			M8 x 1,25	3304508				

SW 11		/square		Ref.- No.:				
L1	L2	angle	thread	steel	brass	V2A	V4A	
5,5	18	90°	M10 x 1,0	3304709				
			R 1/8, 1/8 - 28 BSP	3304756				