

■ UMETA Flush-Type Grease Nipples



Type D2



- according to DIN 3405
- angled version B / 45°
- standard versions according to DIN are made of steel, zinc-plated and passivated, with tapered thread

SW
L1
L2
GW

wrench size
thread length
total length
thread

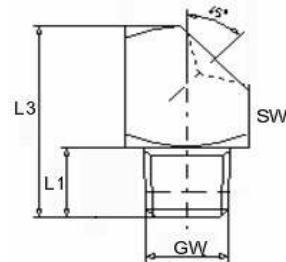

(all measures in mm)

SW 9		/square		Ref.- No.:			
L1	L2	angle	thread	steel	brass	V2A	V4A
5,5	15	45°	M6 x 1,0	3204504			
			M8 x 1,0	3204507			
			M8 x 1,25	3204508			

SW 11		/square		Ref.- No.:			
L1	L2	angle	thread	steel	brass	V2A	V4A
5,5	15	45°	M10 x 1,0	3204709			
			R 1/8, 1/8 - 28 BSP	3204756			