

UMETA Flush-Type Grease Nipples



Type D1



- according to DIN 3405
- straight version A / 180°
- standard versions according to DIN are made of steel, zinc-plated and passivated, with cylindrical thread
- for further types and materials, please see table, or upon request

SW
L1
L2
GW
(all measures in mm)

wrench size
thread length
total length
thread

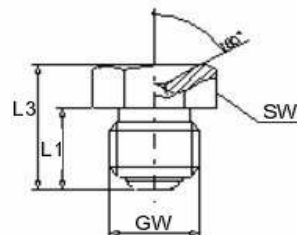

SW 7			Ref.- No.:			
L1	L2	thread	steel	brass	V2A	V4A
6	9	M6 x 0,75	3100723			
		M6 x 1,0	3100724	3110724	3120724	
		1/4" -28 NF/UNF/SAE	3100742			

SW 9			Ref.- No.:			
L1	L3	thread	steel	brass	V2A	V4A
6,5	9,5	M8 x 1,0	3100925	3110925	3120925	
		M8 x 1,25	3100926	3110926	3120926	

SW 11			Ref.- No.:			
L1	L2	thread	steel	brass	V2A	V4A
6,5	9,5	M10 x 1,0	3101127	3111127	3121127	
		M10 x 1,5	3101128			
		G1/8, 1/8 - 28 BSPP	3101161	3111161	3121161	

SW 14			Ref.- No.:			
L1	L2	thread	steel	brass	V2A	V4A
9,5	14	M12 x 1,5	3101461	3111431		
		G1/4, 1/4 - 19 BSPP	3101462	3111462	3121462	

SW17			Ref.- No.:			
L1	L2	thread	steel	brass	V2A	V4A
9	14,5	G3/8, 3/8 - 19 BSPP	3101763			
		S 8 x 1				