



■ UMETA Button-Head Grease Nipples

Type M22



- head Ø 22 mm
- according to DIN 3404
- straight version A / 180°
- standard versions according to DIN are made of steel, zinc-plated and passivated, with cylindrical thread
- for further types and materials, please see table, or upon request

SW wrench size
L1 thread length
L2 total length
GW thread
(all measures in mm)

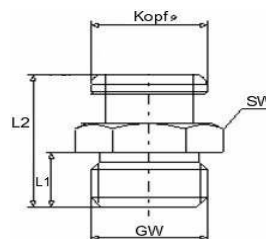

Instructions for installation: necessary space

e = 60 mm/2-39/64"
m = 36 mm/1-27/64"
r = 18 mm/23/32"
g = 45 mm/1-25/32"

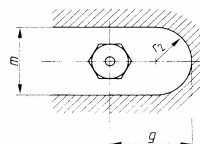
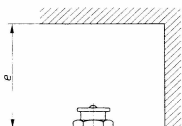

SW 22				Ref.- No.:			
L1	L2		thread	steel	brass	V2A	V4A
8	21,5		M16 x 1,5	4302219	4312219	4322219	
			G 1/4, 1/4 - 19 BSPP	4302262	4312262	4322262	
			G 3/8, 3/8 - 19 BSPP	4302263	4312263	4322263	
			G 1/2	4302264			

Type M22/L



- head Ø 22 mm
- with extended neck
- according to DIN 3404
- straight version A / 180°
- standard versions according to DIN are made of steel, zinc-plated and passivated, with cylindrical thread
- for further types and materials, please see table, or upon request

SW wrench size
L1 thread length
L2 total length
L3 neck length
GW thread
(all measures in mm)

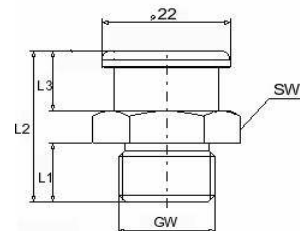

SW 22				Ref.- No.:			
L1	L2	L3	thread	steel	brass	V2A	V4A
11,5	28	11	G 1/4, 1/4 - 19 BSPP	4402262			
			G 3/8, 3/8 - 19 BSPP	4402263			
			G 1/2, 1/2 - 14 BSPP	4402264			