

Type H1



Hydraulic-Type Grease Nipples

- according to DIN 71412
- straight version A / 180°
- standard versions according to DIN are made of steel, case-hardened, zinc-plated and passivated
- for further types and materials, please see table, or upon request



SW wrench size
L1 thread length
L2 total length
L3 shank length
GW thread

(all measures in mm)

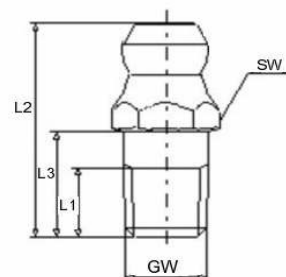

SW 7				Ref.- No.:			
L1	L2	L3	thread	steel	brass	V2A	V4A
4	13,5		M6 x 1,0	5241007	5241101	5241102	
			1/4" -28 NF/UNF/SAE	5241054	5241103		
5,5	15		M 5 x 0,8	1100701	1110701	1120701	
			M6 x 0,75	1100703	1110703	1120703	
			M6 x 1,0	1100704	1110704	1120704	1140704
			1/4" -28 NF/UNF/SAE	1100737	1110737	1120737	
			1/4"-26 BSF	1100744	1110744	1120744	
			1/4" BSW	1100750			
5,6	17,3	8,5	M6 x 1,0	5241038			
			1/4" -28 NF/UNF/SAE	5241055			
			1/4"-26 BSF	5241056			
6	24	14	M6 x 1,0	5241057			
			1/4" -28 NF/UNF/SAE	5241058			
			1/4"-26 BSF	5241059			
8,3	29	19	M6 x 1,0	5241060			
			1/4" -28 NF/UNF/SAE	5241061			
			1/4"-26 BSF	5241062			
6	41	31	M6 x 1,0	5313742			
			1/4" -28 NF/UNF/SAE	5241080			

SW 9				Ref.- No.:			
L1	L2	L3	thread	steel	brass	V2A	V4A
4	14		5/16"-24 NF/UNF/SAE	5241068			
5,5	15		M7 x 1,0	1100905			
			M8 x 0,75	1100906			
			M8 x 1,0	1100907	1110907	1120907	1140907
			M8 x 1,25	1100908	1110908	1120908	1140908
			5/16"-24 NF/UNF/SAE	1100938	1110938	1120938	
			5/16" -22 BSF	1100945			
			5/16" BSW	1100951			
8,5	18,5		M8 x 1,0	5241009			
6	43	33	2-parts R 1/8 -28 BSP	5241070			
6,5	45	35	2-parts 1/8" -27 NPT/PTF	5241076			
8	65	55	2-parts 1/8" -27 NPT/PTF	5241077			

Type H1



Hydraulic-Type Grease Nipples
- according to DIN 71412
- straight version A / 180°

SW 11				Ref.- No.:				
L1	L2	L3	thread	steel	brass	V2A	V4A	
5,5	15		M6 x 1,0	1101104		1121104		
				M10 x 1,0	1101109	1111109	1121109	1141109
				M10 x 1,25	1101110			
				M10 x 1,5	1101111	1111111	1121111	1141111
				3/8" -24 UNF/NF/SAE	1101139	1111139	1121139	
				3/8" -20 BSF	1101146			
				3/8" WHIT/BSW	1101152			
				R 1/8, R 1/8 - 28-BSP	1101156	1111156	1121156	1141156
	1/8" -27 NPT/PTF	1101167	1111167					
7,5	17,5		M10 x 1,0	5241074				
				1/8" -27 NPT/PTF	5241024	5241105	5241106	
6	31	21	1/8" -27 NPT/PTF	5241075				

SW 14				Ref.- No.:				
L1	L2		thread	steel	brass	V2A	V4A	
6,5	17,5		R1/4, 1/4 -19 BSP	1101457	1111457	1121457	1141457	
				1/4" -18 NPT/PTF	1101468			
				M12 x 1,0	1101412			
				M12 x 1,25	1101413			
				M12 x 1,5	1101414	1111414	1121414	
				M12 x 1,75	1101415		1121415	
8	19		R1/4, 1/4 -19 BSP	5241071				
				1/4" -18 NPT/PTF	5241072			

SW 17				Ref.- No.:				
L1	L2		thread	steel	brass	V2A	V4A	
7	18		R3/8, 3/8 -19 BSP	1101758		1121758		
				M16 x 1,5	1101719			
				3/8" -18 NPT/PTF	1101769			