

■ UMETA Button-Head Grease Nipples



Type M4



- head Ø 10 mm
- according to DIN 3404
- straight version A / 180°
- standard versions according to DIN are made of steel, zinc-plated and passivated, with cylindrical thread
- for further types and materials, please see table, or upon request

SW wrench size
L1 thread length
L2 total length
GW thread
(all measures in mm)

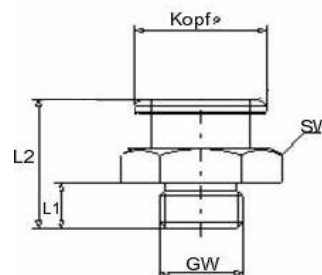

Instructions for installation: necessary space

e = 50 mm/2-11/64"
m = 26 mm/1-17/64"
r = 14mm/41/64"
g = 30mm/1-25/64"



SW 11			Ref.- No.:			
L1	L2	thread	steel	brass	V2A	V4A
6	13,5	M6 x 1,0	4201104			
		M8 x 1,0	4201107			
		M10 x 1,0	4201109			
		G 1/8 1/8 -28 BSPP	4201161		4221161	